

4

3

2

1

THESE DRAWINGS AND SPECIFICATIONS ARE THE PROPERTY OF JBL INCORPORATED.
THEY ARE ISSUED IN STRICT CONFIDENCE AND SHALL NOT BE REPRODUCED OR USED
AS THE BASIS FOR MANUFACTURE OR APPARATUS WITHOUT WRITTEN PERMISSION.

REVISIONS			
LTR	DESCRIPTION	DRFT	DATE
A	RELEASE TO MARKETING	AD	3/02/2017

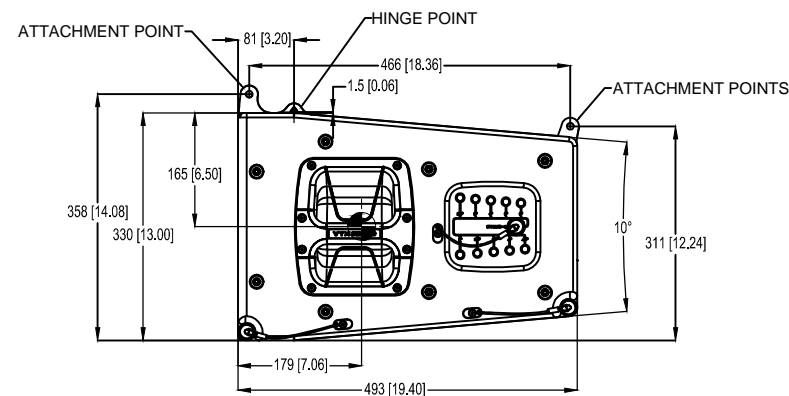
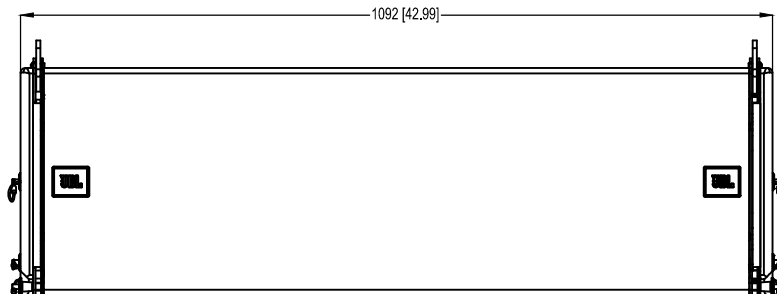
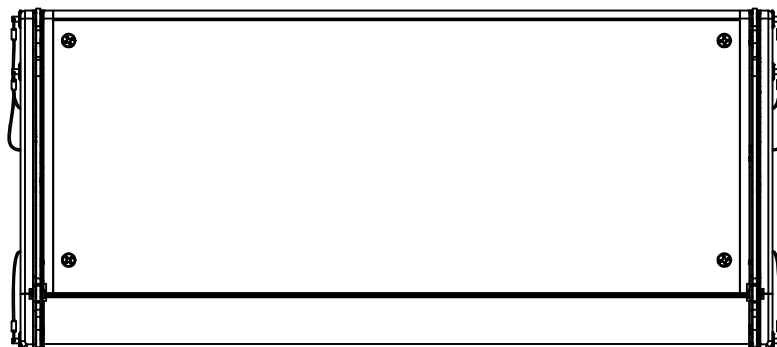

1. COMPONENTS: 2XJBL 2264H, 4XJBL 2165H, 3XJBL 2423K
2. INPUT CONNECTORS: 2XNEUTRIK SPEAKON NL-8
3. GRILL: 14GA PERFORATED STEEL POWDERCOATED BLACK AND CLOTH BACKING
4. MATERIAL: 15MM BIRCH PLYWOOD
5. FINISH: BLACK DURAFLEX
6. WEIGHT: 61KG

Ⓢ CENTER OF GRAVITY (CG)

NOTES: (UNLESS OTHERWISE SPECIFIED)

TOLERANCES

(UNLESS OTHERWISE SPECIFIED)

X.XX ± .063 INCH
X.X ± .125 INCH

ANGULAR TOLERANCE OF 0°±30°

FRACTIONAL DIMENSIONS ± 1/32

* DIMENSIONS ARE MM [INCHES]

* ALL DIMENSIONS ARE FINISHED DIMENSIONS

* DO NOT SCALE DRAWING



JBL PROFESSIONAL
A Harman International Company
Northridge, California 91329 U.S.A.

TITLE			
CUSTOMER DRAWING, VTX-A12			
SIZE	DRAWING NO.	REV	
A	1000303221	A	
SCALE	SHEET	OF	
NTS	1	1	